

Assembly Instructions

BOUCLE SWIVEL CHAIR

Ax1

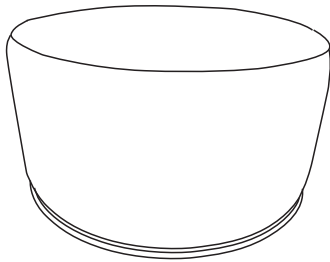

Dx4

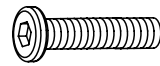

M8x60mm

Bx1

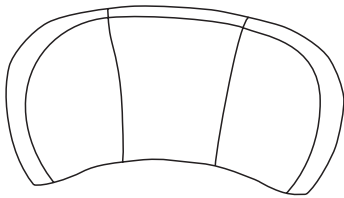

Ex4

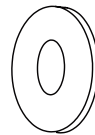

M8

Cx1

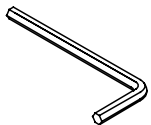

Fx4



M8

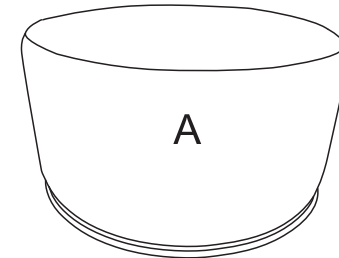
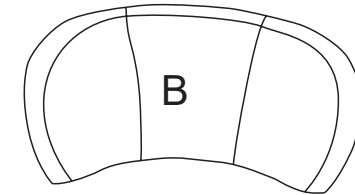

Do not tighten the screws fully during assembly.
Fully tighten screws after the final assembly steps

STEP 1

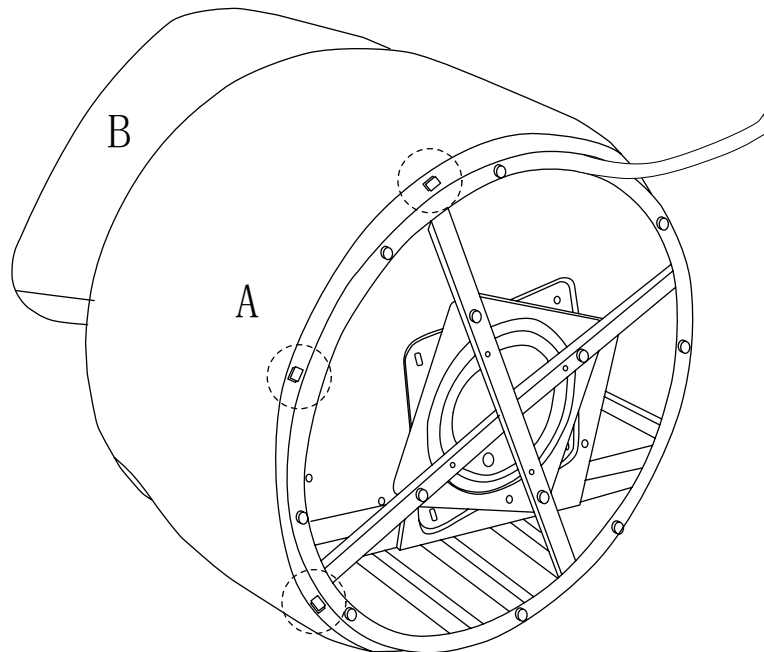

Before assembly, please remove the small wooden blocks and the non-woven fabric on the tube.

STEP 2

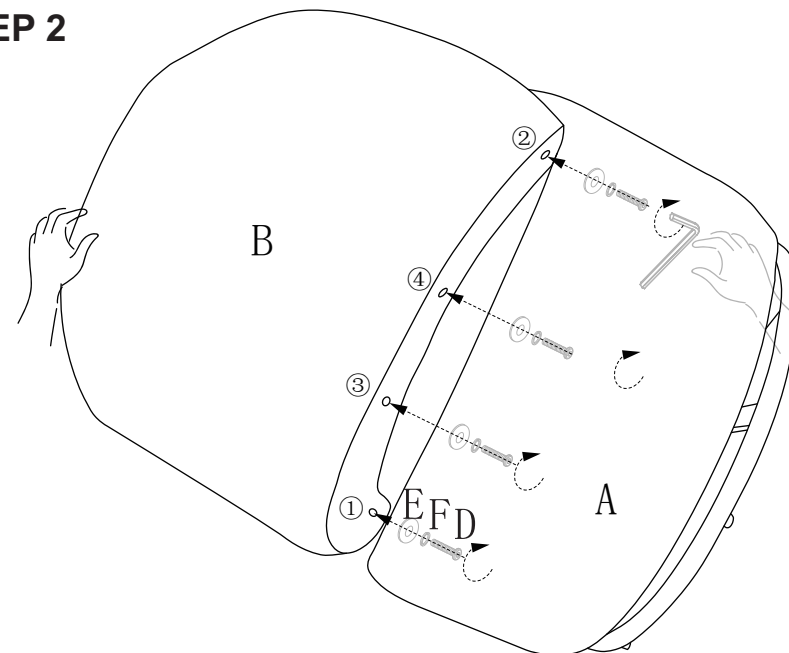

According to the order of the holes, twist each screw by a third.

ATTENTION: DO NOT TURN THE BASE DURING ASSEMBLY.

STEP 3

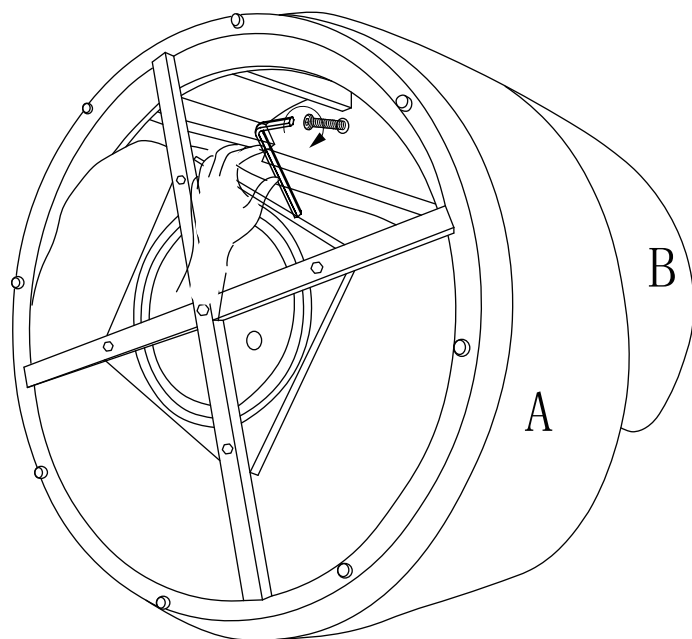

Turn the chair over and tighten the screws.

ATTENTION: DO NOT TURN THE BASE DURING ASSEMBLY.

STEP 4

